

**Desono**  
**P30DT & P60DT Pendant Loudspeakers**  
**Installation Guide**



**Models**

P60DT-BL  
P60DT-W  
P30DT-BL  
P30DT-W

## PRODUCT DESCRIPTION

The P30DT (4.25") and P60DT (6.5") two-way, pendant loudspeakers bring exceptional dispersion to areas and rooms with open ceilings, while offering a clear speech and musical purity. Available in black or white, both Biamp P30DT and P60DT are suitable for a wide range of background and foreground sound applications.

The dual Gripple™ wire suspension system, euroblock in/out connector, loudspeaker cables and 70/100 volt power rotary with 16 ohms connectivity can be hidden after installation by the innovatively designed end-cap. The attractive aesthetics and ease-of-installation make this product an industry standard.

**NOTES:**

- These loudspeakers are designed for indoor use only.
- Operational temperature range: 0° to +35°C (32° to 95°F)

## FEATURES

- High performance, attractive aesthetics, and ease of installation
- Installer-friendly end cap with cut-out slot and integrated magnetic fixing, hiding the power selector and cable connections can be installed after the loudspeaker is hung
- Two Gripples and snaphook wire suspension cables are included for a safe and secure, fast and simple installation
- Handy euroblock connector with permanent pass-through allows for a quick install and easy daisy-chaining of multiple loudspeakers
- Easily accessible rotary tap switch to select 70/100 volt power or low impedance (16 ohms) operation
- Tuned bass reflex port for optimised low frequency performance
- High intelligibility while retaining perfect music reproduction quality
- Available in black or white



# IMPORTANT INSTRUCTIONS

Read and follow the Safety information included in the carton.

**IMPORTANT:** This loudspeaker is designed for indoor use only, and should not be installed in wet or damp environments, or in locations where moisture or water may enter the loudspeaker. Refer all servicing to qualified service personnel. Servicing is required when the loudspeaker has been damaged in any way, such as liquid has gotten into the device, the loudspeaker does not operate normally, or has been dropped.

The terms CAUTION, WARNING, and DANGER may be used in this manual to alert the reader to important safety considerations. If you have any questions or do not understand the meaning of these terms, do not proceed with installation. Contact your local dealer, distributor, or call Biamp directly for assistance. These terms are defined as:



**CAUTION:** describes an operating condition or user action that may expose the equipment or user to potential damage or danger.



**WARNING:** describes an operating condition or user action that will likely cause damage to the equipment or injury to the user or to others in the vicinity.



**DANGER:** describes an operating condition or user action that will immediately damage the equipment and/or be extremely dangerous or life threatening to

the user or to others in the vicinity.

These installation instructions are for use by qualified personnel only. To reduce the risk of fire or electric shock do not perform any servicing other than that contained in the operating instructions unless you are qualified to do so.

## UNPACKING / INSPECTION

The loudspeakers are engineered and manufactured to be rugged and they are carefully packed in sturdy cartons. However, it is recommended to thoroughly inspect each unit after it has been removed from the packaging, as damage could occur during shipping.

Please note that once the shipment has left your dealer or the factory, the responsibility for damage is always borne by the freight company. If damage has occurred during shipping, you must file a claim directly with the freight company. It's very important to contact the freight company as soon as possible after receiving your shipment, as most freight companies have a short time limit within which they will investigate claims. Make sure to save the carton and the packing material, as most claims will be denied if these materials are not retained. Your Biamp dealer and the factory will try to help in any way they can, but it is the responsibility of the party receiving the shipment to file the damage claim.



**CAUTION:** Installation of these loudspeakers should only be performed by trained and qualified personnel. It is strongly recommended that a licensed and certified professional structural engineer approve the mounting. It is essential that all installation work involving the suspension of these loudspeaker products be performed by competent, knowledgeable persons who understand safe rigging practices. Severe injury and/or loss of life may occur if this product is improperly installed.

# CONTENTS

Each carton contains the following:

- Loudspeaker (x1)
- End cap with integrated cable cover (x1)
- Gripple snaphook cable 5m (x2)
- Gripple express locking device (x2)
- Important safety instructions (x1)

*Loudspeaker wiring not included*



**IMPORTANT:** Biamp is not responsible for damages resulting from the negligent installation of any loudspeaker.



**WARNING:** Please make sure that the mounting structure is capable of safely supporting the loudspeaker's weight.

## LOUDSPEAKER INSTALLATION

To install the pendant loudspeaker, do the steps that follow:

**Note:** Loudspeaker images shown in this manual are of the P30DT, but installation is the same for the larger P60DT.

1. Thread the snaphook cable through the opening in the locking device (Gripple) in the direction of the arrow shown on the unit.
2. Loop the snaphook cable over or through a secure structure, and pass the cable back through the Gripple, using the closest opening (2). Pressing the appropriate button will allow the cable to move through that side of the device.
3. Repeat steps 1 and 2 for both the primary and secondary suspension cables.

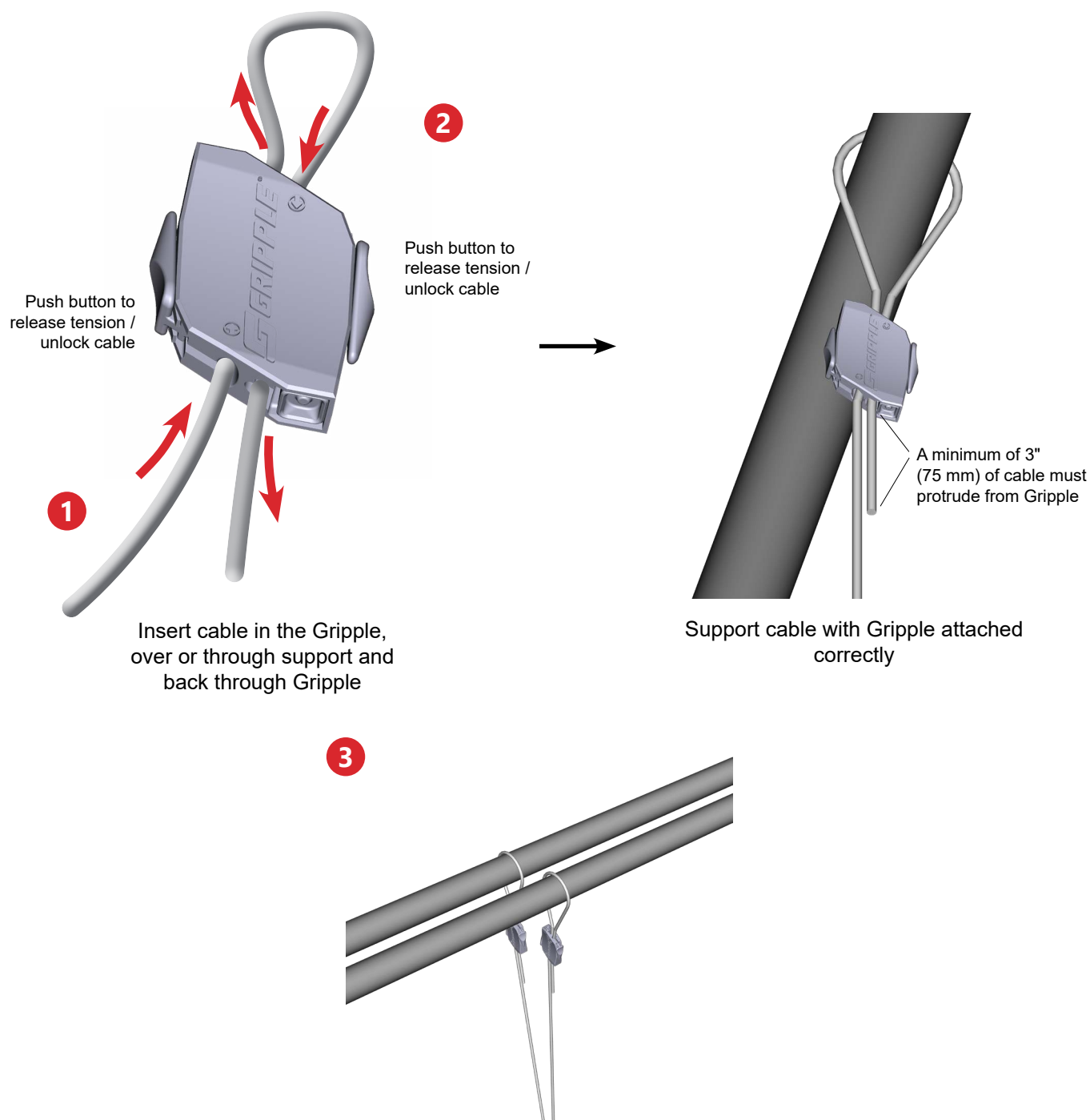

## INSTALLATION (continued)

4. Connect the snaphook on the primary cable through the central mounting point on the loudspeaker.
5. Connect the snaphook on the secondary safety cable through one of the remaining mounting points.
6. Adjust the length of the primary cable so the loudspeaker hangs at the desired height as shown (a). Adjust the length of the secondary safety cable, allowing some slack (b) so the loudspeaker hangs straight on the primary cable.

4



Attach primary cable snaphook in center hole

5



Attach secondary (safety) cable snaphook in a different bracket hole

6

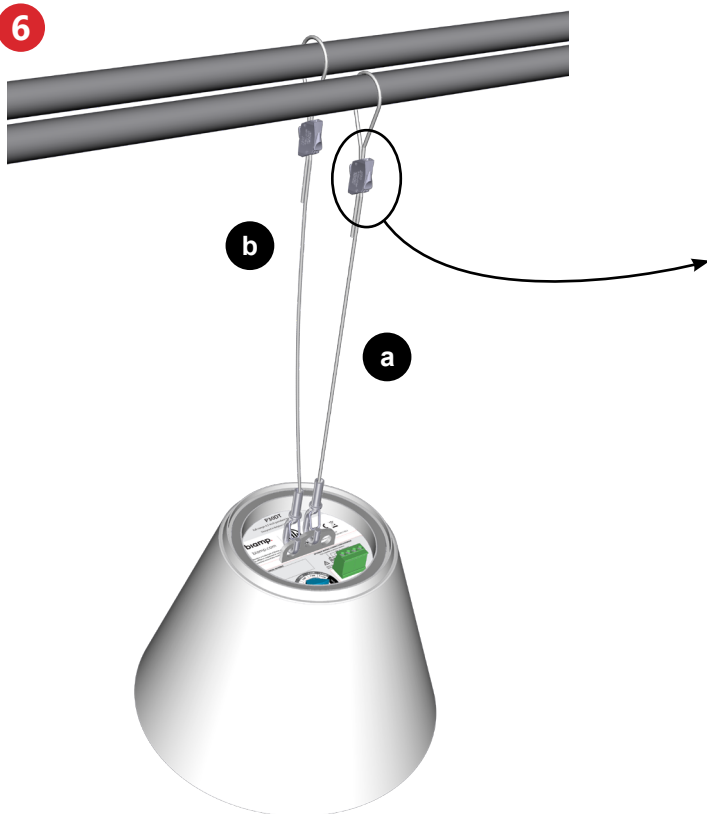

Allow slack in secondary cable (b) so pendant hangs straight



**IMPORTANT:** When adjusting the length, always leave a minimum of 3" (75mm) of cable protruding from the locking device.

INSTALLATION (continued)

7. Attach the loudspeaker cables according to whether you are connecting a single loudspeaker or daisy chaining more than one.

7

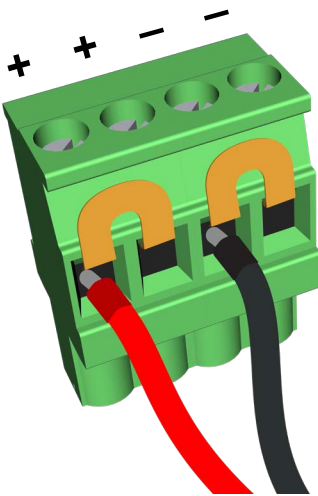

Wire single loudspeaker

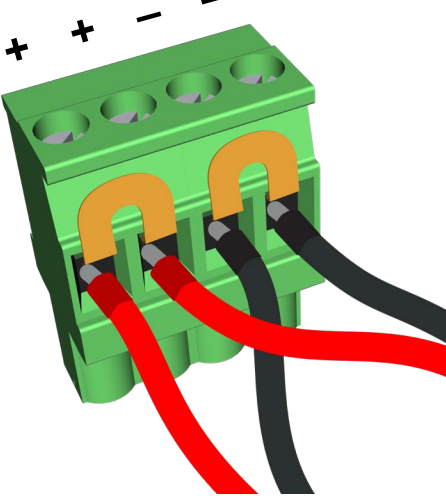

Daisy chain multiple loudspeakers



**Note:** It is strongly recommended to use wire ferrules with stranded wire. Recommended wire size: 0.5 mm<sup>2</sup> - 2.5mm<sup>2</sup> (AWG 20 ga - 10 ga)

Use the appropriate gauge and length of wire to avoid appreciable signal loss based on the number of devices per run.

8. Press the wired euroblock onto the corresponding male euroblock connector on the top of the loudspeaker.

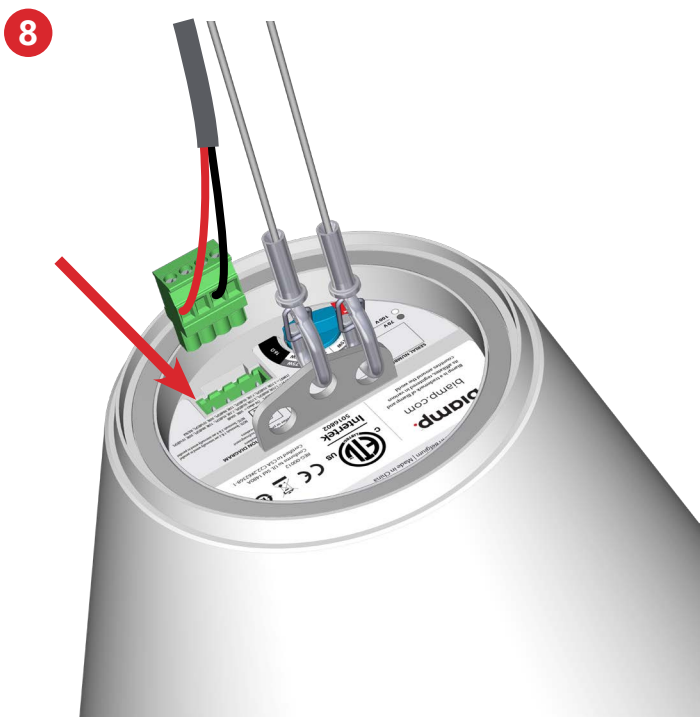

Install euroblock

9. Rotate knob to select the appropriate power tap setting on the top surface of the loudspeaker.

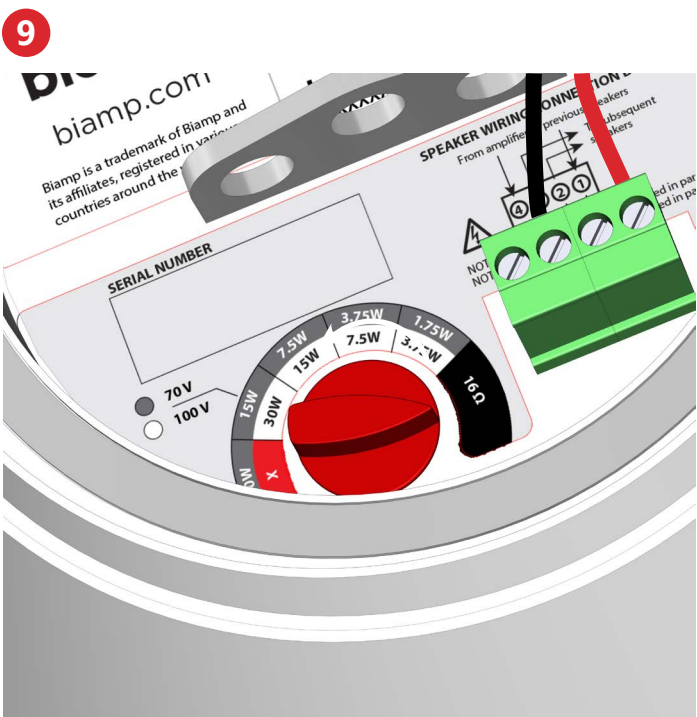

Tap knob detail



**WARNING:** Set the power tap prior to applying audio and only change the setting while the audio amplifier is "OFF" and unplugged from the AC main power supply.

**WARNING:** The 16 ohm setting is not compatible with 70 volt or 100 volt line amplifiers!

**WARNING:** The highest 70 volt power setting is not compatible with 100 volt line amplifiers, only with 70 volt line amplifiers.

## INSTALLATION (continued)

10. Attach the end cap by placing it around the suspension and loudspeaker cables. Make sure the end cap is held firmly in place with the magnets.

10

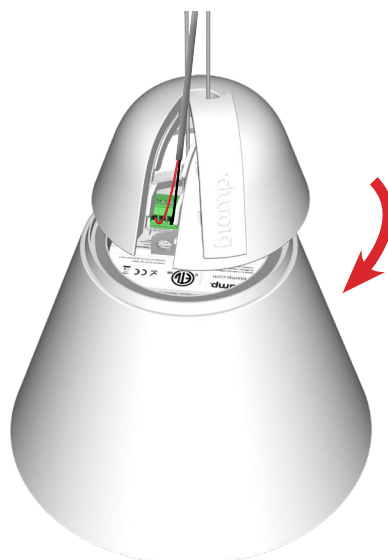

11. Ensure the tether is securely inserted in the cable cover and end cap sockets. Clip the cover into the end cap.

11

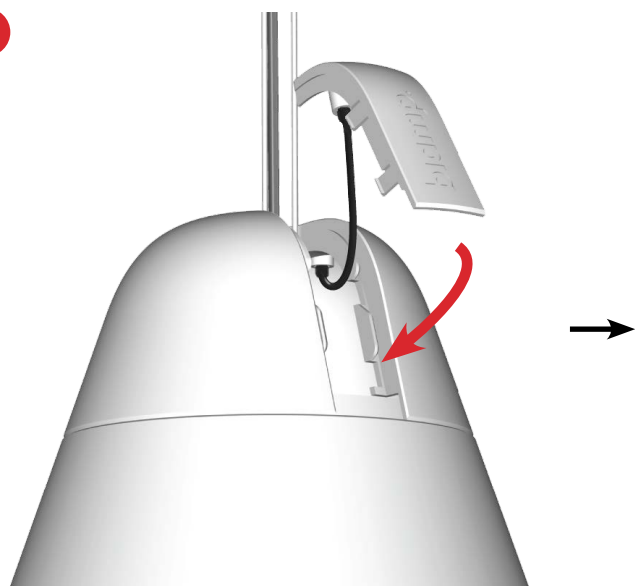

12. Rotate the end cap so that the secondary cable does not press against the cable cover. There should be enough slack in the secondary cable that it doesn't rub against either the end cap or cable cover.

12

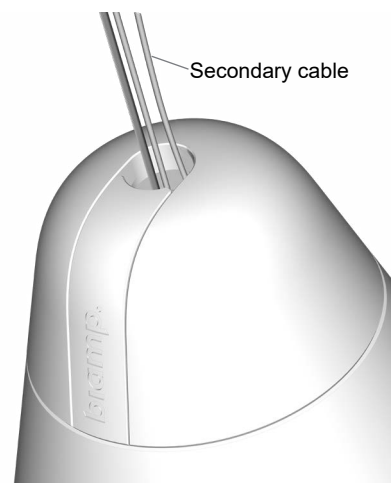

DIMENSIONS

P30DT

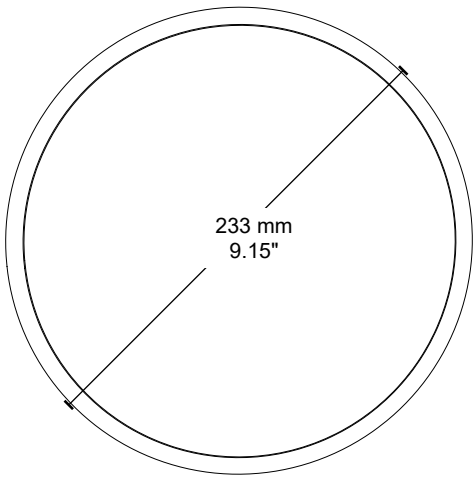
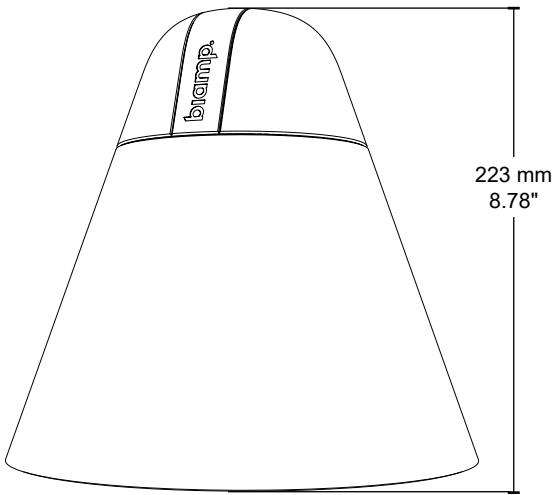

P60DT

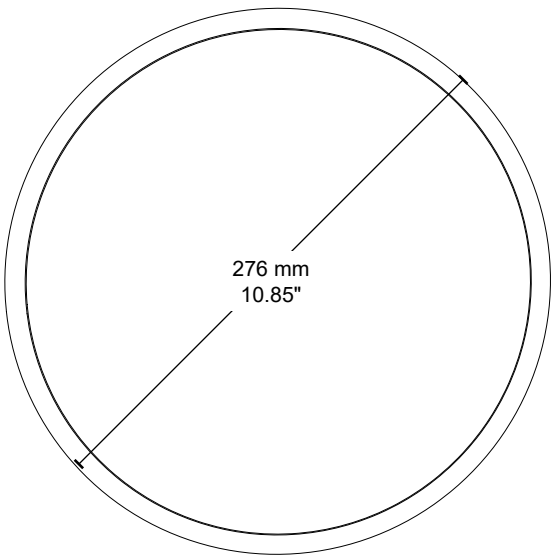
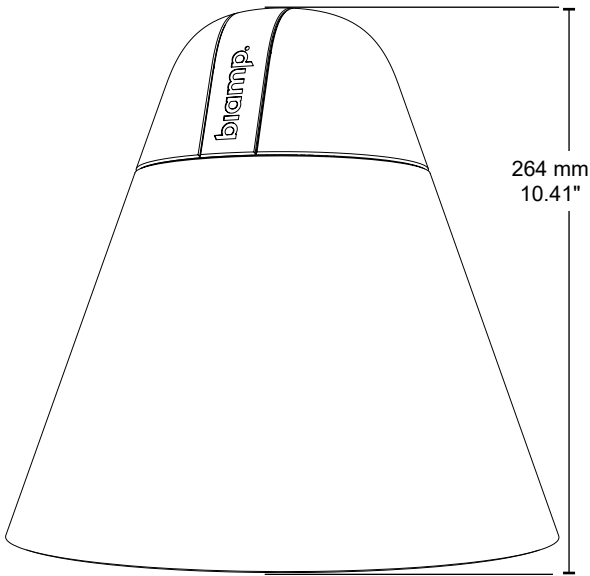

## CONTACT US

Email: [support@biamp.com](mailto:support@biamp.com)

Web: [support.biamp.com](https://support.biamp.com)

Warranty: [biamp.com/legal/warranty-information](https://biamp.com/legal/warranty-information)

Safety & Compliance: [biamp.com/compliance](https://biamp.com/compliance)