

## Required items:

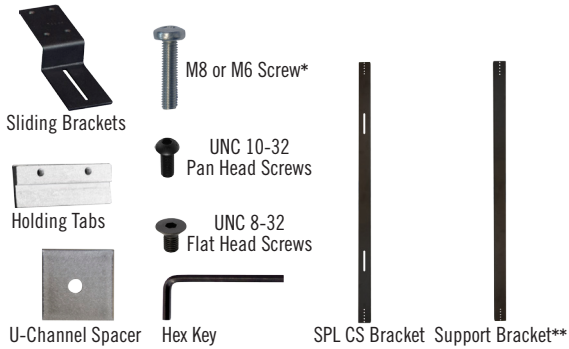

\* Provided with display unit

\*\* Required if supplied

## Optional items:



Bar Spacer

## SPL CS Wiring Guide:

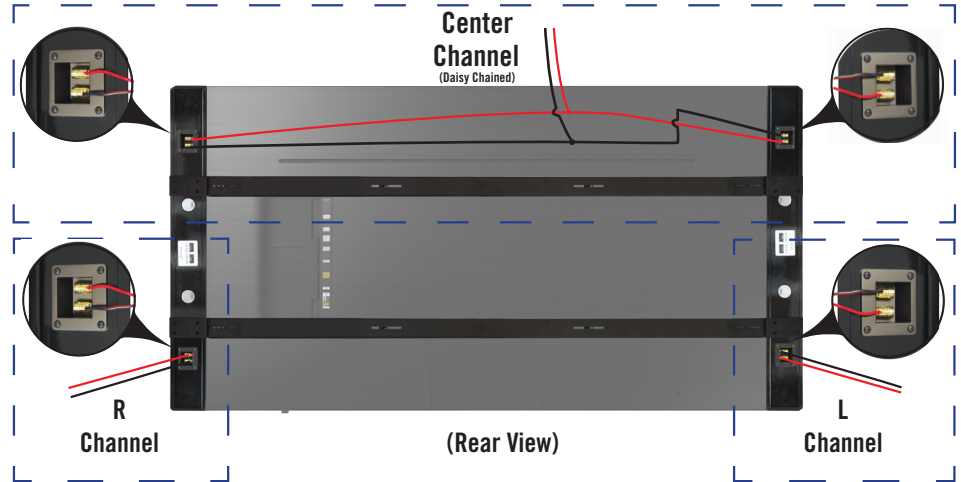

## Assembly Guide:



- 1 Before proceeding, place the display on a padded surface.



- 2 Align the SPL CS brackets to the VESA pattern on the rear of the display. If provided, the support bracket should be used for additional rigidity when mounting bars.



- 3 Once brackets are aligned to the VESA pattern of the display, place U-channel spacers into the U-channel of the bracket. This will add additional surface area for mounting your display's wall brackets.



- 4 Now, loosely mount the SPL CS brackets, and the display wall mounting brackets of your choice, to the rear of the display using the M8 or M6 screws provided with your display.

# SPL CS MOUNTING BRACKET

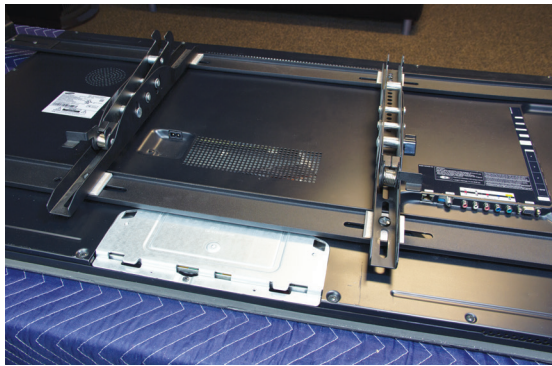

- 5** Repeat step 4 until each SPL CS bracket and the TV mount is loosely mounted to the TV's VESA pattern.



- 6** Loosely tighten the sliding bracket to the VESA bracket using the pan head socket screws and provided hex key.



- 7** If desired, the bar spacers can be added to adjust the offset the SoundBar by inserting the bar spacer between the sliding bracket and the rear of the SoundBar.

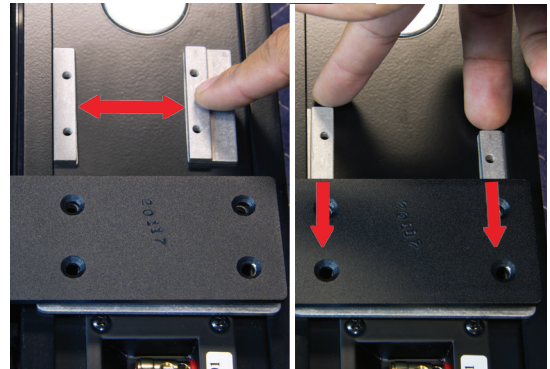

- 8** Place holding tabs on the rear of the SoundBar and insert them into the mounting channel. Then align the mounting tab's threaded holes to the countersunk holes of the sliding bracket.



- 9** Firmly tighten each of the four provided flathead socket screws. Then finish tightening the sliding brackets while applying constant pressure on the SoundBar towards the display for best results.



- 10** Repeat these steps for the opposite side. Complete the bracket installation by tightening any remaining loose fasteners.

