

DM-TX-201-S/DM-TX-201-S2

DigitalMedia 8G™ Fiber Transmitters 201

DO Install the Device

The DM-TX-201-S and DM-TX-201-S2 can be mounted onto a flat surface or onto a rack rail.

Mounting onto a Flat Surface

Using four mounting screws (not included), mount the device onto a flat surface such as a wall or a ceiling. Mounting of the device on a wall is shown in illustration ❶.

❶ Mounting onto a Flat Surface

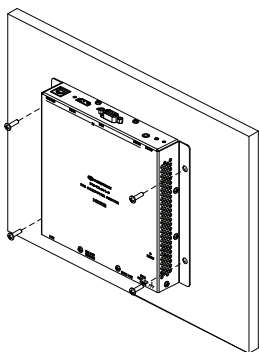

Mounting onto a Rack Rail

The DM-TX-201-S and DM-TX-201-S2 mount onto the front or rear rail of a rack. Position either the left or right mounting flange of the device so that the holes align with the holes in the rack. Then, secure the device to the rack using two rack mounting screws (not included). Mounting of the right flange of the device is shown in illustration ❷.

❷ Mounting onto a Rack Rail

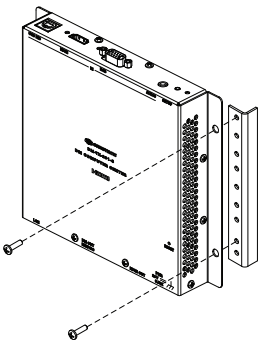

DO Check the Box

QTY	PRODUCT	PART NUM.
1	Power Pack, 24 Vdc 0.75 A, 100-240 Vac	2045865

Not Included: Cables, Mounting Screws

DO Connect the Device

Connect the device as appropriate for the installation. Refer to illustrations ❸ through ❹.

❸ Connections to the DM-TX-201-S Front Panel

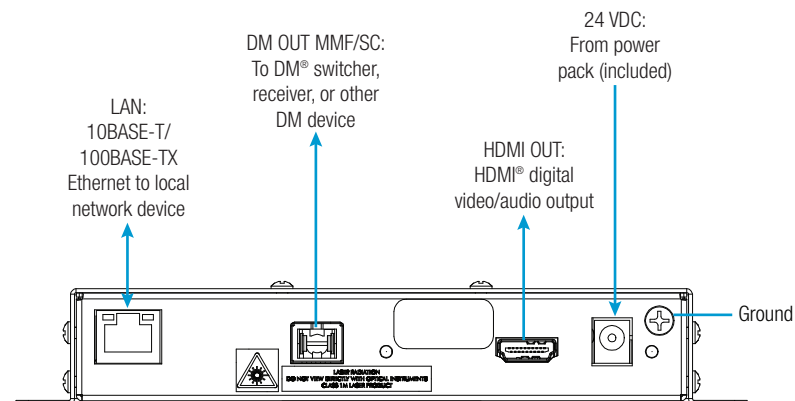

❹ Connections to the DM-TX-201-S2 Front Panel

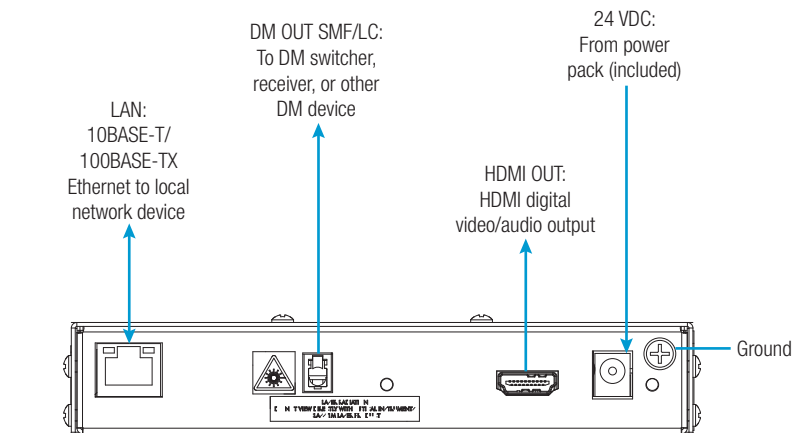

5 Connections to the DM-TX-201-S and DM-TX-201-S2 Rear Panel

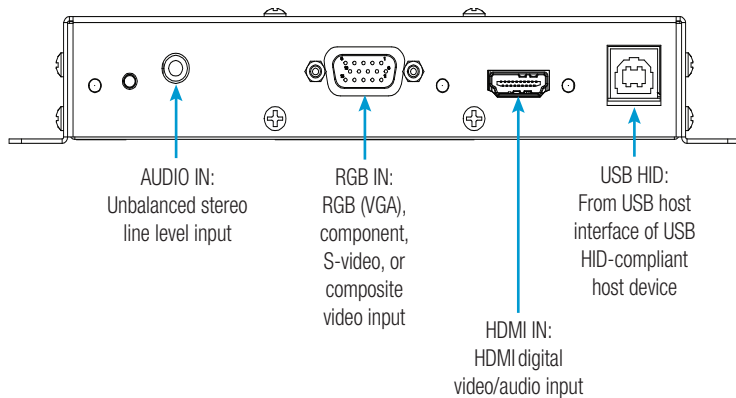

DO Set the IP Address

The configuration of the transmitter within the Crestron® DigitalMedia 8G™ system determines how the IP address of the transmitter is set:

- If the transmitter connects to a DigitalMedia™ switcher, the transmitter is configured by the switcher automatically.
- If the transmitter connects to a DigitalMedia 8G fiber receiver, the transmitter uses its own configuration settings. By default, DHCP (Dynamic Host Configuration Protocol) is enabled. If it is desired that the default IP address be assigned to the transmitter, hold down the **SETUP** button while the unit boots up. The default IP address 192.168.1.237 overwrites the current setting. To manually set a different IP address, use the Crestron Toolbox™ application.

DO Learn More

Visit the website for additional information and the latest firmware updates. To learn more about this product, use a QR reader application on your mobile device to scan the QR image.

Crestron Electronics
15 Volvo Drive, Rockleigh, NJ 07647
888.CRESTRON | www.crestron.com

DM-TX-201-S



DM-TX-201-S2



As of the date of manufacture, the products have been tested and found to comply with specifications for CE marking.



This product is Listed to applicable UL Standards and requirements tested by Underwriters Laboratories Inc.
Ce produit est homologué selon les normes et les exigences UL applicables par Underwriters Laboratories Inc.

Federal Communications Commission (FCC) Compliance Statement

This device complies with part 15 of the FCC Rules. Operation is subject to the following two conditions:

(1) This device may not cause harmful interference, and (2) this device must accept any interference received, including interference that may cause undesired operation.

CAUTION: Changes or modifications not expressly approved by the manufacturer responsible for compliance could void the user's authority to operate the equipment.

NOTE: This equipment has been tested and found to comply with the limits for a Class B digital device, pursuant to part 15 of the FCC Rules. These limits are designed to provide reasonable protection against harmful interference in a residential installation. This equipment generates, uses and can radiate radio frequency energy and, if not installed and used in accordance with the instructions, may cause harmful interference to radio communications. However, there is no guarantee that interference will not occur in a particular installation.

If this equipment does cause harmful interference to radio or television reception, which can be determined by turning the equipment off and on, the user is encouraged to try to correct the interference by one or more of the following measures:

- Reorient or relocate the receiving antenna
- Increase the separation between the equipment and receiver
- Connect the equipment into an outlet on a circuit different from that to which the receiver is connected
- Consult the dealer or an experienced radio/TV technician for help

Industry Canada (IC) Compliance Statement

CAN ICES-3(B)/NMB-3(B)



The products are class 1 laser products. They comply with safety regulations of IEC-60825-1, FDA 21 CFR 1040.11 and FDA 21 CFR 1040.10.

WARNING: Visible and invisible laser radiation when open. Avoid direct exposure to beam.

NOTE: Plug the included dust cap into the optical transceiver when the fiber optic cable is unplugged.

The specific patents that cover Crestron products are listed at patents.crestron.com.

The product warranty can be found at www.crestron.com/warranty.

Crestron, the Crestron logo, Crestron Toolbox, DigitalMedia, DigitalMedia 8G, and DM are either trademarks or registered trademarks of Crestron Electronics, Inc. in the United States and/or other countries. HDMI is either a trademark or registered trademark of HDMI Licensing LLC in the United States and/or other countries. UL and the UL logo are either trademarks or registered trademarks of Underwriters Laboratories, Inc. in the United States and/or other countries. Other trademarks, registered trademarks, and trade names may be used in this document to refer to either the entities claiming the marks and names or their products. Crestron disclaims any proprietary interest in the marks and names of others. Crestron is not responsible for errors in typography or photography.

This document was written by the Technical Publications department at Crestron.

©2016 Crestron Electronics, Inc.