

## RFB4-SS Floor Box Accessories Ordering Information

### RFB-B-SS

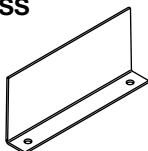

**Internal Blank Bracket** – Used to close off unused gangs.

Country of Origin: Mexico

### RFB-RB-SS

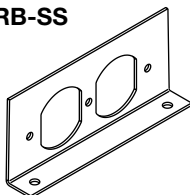

**Internal Duplex Receptacle Bracket** – Accepts standard 15 Amp & 20 Amp Duplex Receptacles.

Country of Origin: Mexico

### RFB-GFI-SS

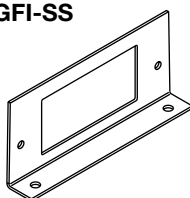

**Internal GFI Receptacle Bracket** – Accepts standard GFCI & Decorator style Receptacles Communication or Audio/Video Devices.

Country of Origin: Mexico

### RFB-2AB-SS

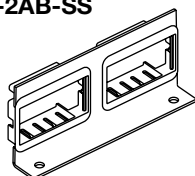

**Internal Bracket** – Two Pass & Seymour Activate adapters included. Wiremold CM Series Open System inserts sold separately.

Country of Origin: Mexico

### RFB-2-SSRT

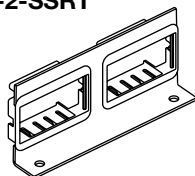

**Communication Bracket** – Ortronics® AB2TJ TracJack and ABS2 Series II adapters included.

Country of Origin: Mexico

### RFB-4TKO-SS

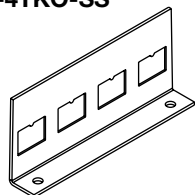

**Internal Bracket** – Four RJ Keystone opening knockouts. Use as blank plate or for up to four RJ openings.

NOTE: Opening dimension is 9/16" x 3/4"  
[14.3mm x 19.1mm].

Country of Origin: Mexico

### RFB4-SS-AAP

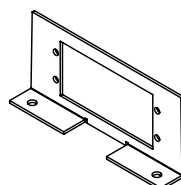

**Internal Audio/Video Bracket** – Accepts two (2) Extron Electronics AAP Series Devices. (Sold separately)

Country of Origin: Mexico

### RFB4-SS-MAAP

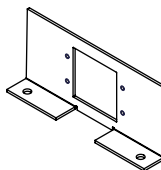

**Internal Audio/Video Bracket** – Accepts two Extron® Electronics MAAP Series Devices. (Sold separately)

Country of Origin: Mexico

### RFBKIT

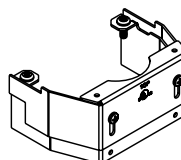

**Barrier Kit** – Barrier kit used to separate power and communication wires in partition feed covers. Supplied with base and three extensions to adjust to cover height. Kit should be used on RFB2, RFB2-OG, RFB2-SS, RFB4 and RFB4-SS Floor Boxes. Kits are sold separately.

Country of Origin: USA

### FP-CTR

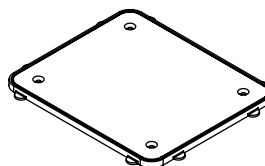

**Bare Concrete & Terrazzo Ring** – Nonmetallic ring for use on bare polished concrete and terrazzo floor applications.

Country of Origin: USA

### PKER

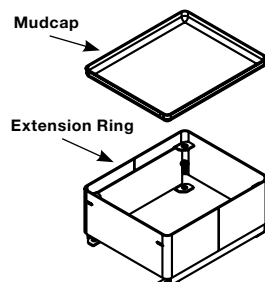

**Extensions** – Attaches to preset to add height to preset. Can be field installed.

Extension	Height Above Preset "A"
PKER-10	1" [25mm]
PKER-15	1 1/2" [38mm]
PKER-20	2" [51mm]
PKER-25	2 1/2" [64mm]
PKER-30	3" [76mm]

Country of Origin: USA

### S3AXB

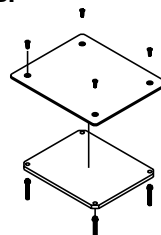

**Blanking Plate** – Aluminum top plate with steel support plate and four (4) adjusting screws.

Country of Origin: USA